

PART 1	REV 2.000	DATE 18-Apr-99
-----------	--------------	-------------------

IMPORTANT: This drawing shows
the position the guide rails from
the TOP of UEC looking DOWN.

Big Keyway, Front

UEC-2 Access Covers This Side

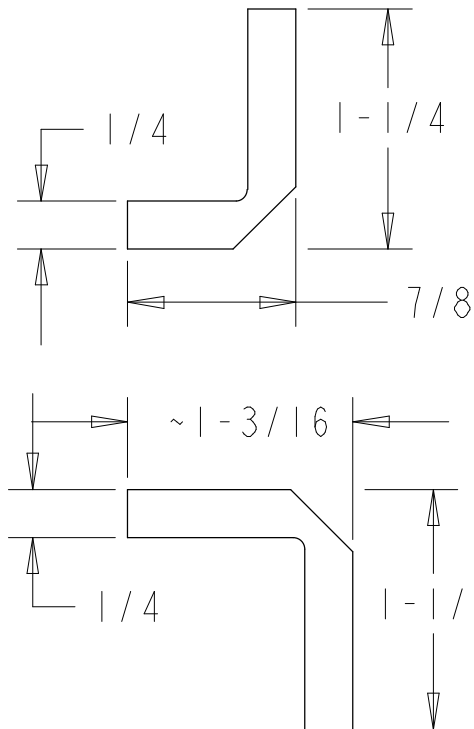

Small Key, Front

Big Keyway, Back

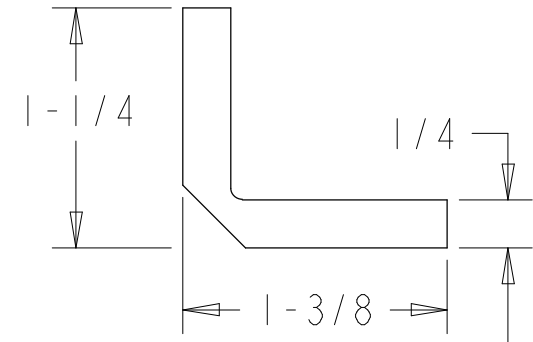

Chamfer occurs as
part of bending process.

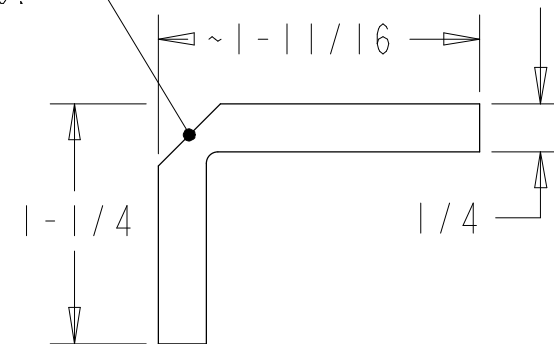

Small Keyway, Back

UEC-2 Mounting Latch This Side

The parts are the guides for fitting the
UEC into the NAVNET tubes. They are made
by bending an oversized piece of Lexan
and then cutting it down to the dimensions
shown above. These dimensions are only
applicable when using FIBOX enclosures
measuring 5 inches by 7.5 inches by X inches
The guilds are 12 inches long for the 15 inch
bays, and 9 inches long for the 11 inch bays

UNITS/TOL All dimensions in inches unless otherwise specified. Interpret per ANSI Y14.5 Tolerances X.XXX = ± 0.001 X.XX = ± 0.01 unless otherwise specified. Property of UEC Project DO NOT USE OR COPY WITHOUT PERMISSION	MIT NROTC UEC Project		
	TITLE Guiderails		
	MAT'L 0.25 inch Lexan	SCALE 1.000	SHEET 1 OF 1
	DRAWN BY R. Cortesi	FILES GUIDERAILS LONGBIGFRONT	